

NAVIGATORS presents BAR.CO



Main Specification

Type:	Flybridge Motor Yacht	Builder:	Geta Genel Tasarin, Turkey
Model:	Atlantic 25	Year:	1991
Registry:	Düsseldorf/Germany	Construction:	Steel
Classification:	build under Lloyd's		
Accommodation	7 guests in 4 cabins / 4 crew in 2 cabins		
Location:	Palma de Mallorca	Contact:	Navigators International
Asking Price:	1.100.000 EUR (VAT paid)		

Dimensions

Length O.A.:	25,8 m / 84'6"
Beam:	6.00 m / 19'7"
Draft:	2.10 m / 6'11"
Gross tonnage:	140 GT
Net tonnage:	73 tons

Performance

Maximum speed:	12 knots
Cruising speed:	10 knots
Fuel consumption:	65 lph 10 knots
Range:	2.500 nm @ 8 knots

Machinery

Engines:	2 x Caterpillar 3406B, 300 HP
Engine hours:	2.530
Generators:	2 x G&M 25 kW, 1 G&M 9 kW
Generator hours:	4.200

Propulsion

Steering:	Twin rudder electro-hydraulic steering system
Propellers:	2 x 4 blade propeller
Gearbox:	Caterpillar

Auxiliary Equipment

Bow thruster:	75 hp Richfield hydraulic Thrusters
Water maker:	Marinco 3.000 litre/day
Fresh water pressure:	1 x 230 V Pump (new 2008), 2 x 24 V Pumps (tanks new 2008)
Hot water:	240 litre with 2 heating rods (new 2008)
Stabilizers:	Vosper Series 100
Black/grey water system:	2 Jabsco utility pumps for discharge (new 2007)
Fuel purifier:	Separ KWA-52UT
Air-conditioning:	Lunair reverse cycle, throughout

Tankage

Fuel:	11.000 l main tank, 2 day tanks 1.000 l each
Consumption (approx):	40 lph @ 8 knots approx.
Fresh water:	6.500 l
Grey water:	3.050 l
Black water:	2.090 l

Electrical System

Batteries:	800 Ah/24 V service batteries AGM (new 2006) 2 x 180 Ah/24 V starter batteries CAT (new 2006) 2 x 100 Ah/24 V starter batteries generator 1 & 2 (new 2007) 50 Ah/12 V starter battery generator 3 (new 2007)
Shore power:	220 V 63 Ah
Charger / Inverter:	3 Mastervolt 24/2000-60 charger/inverter for service bat (2007) 1 Mastervolt Charge Master 24/40-3 for CAT starter bat (2008) 1 Sterling charger AB24-150 for service bat (from CAT) (2007)

Up to 18 hours on inverter, recharging time 3 hours

Navigation Equipment

Navigation Computer:	2 VISTA-PC (1 as backup and Media centre) (new 2008) <ul style="list-style-type: none"> • Transas Navigator software with integration of <ul style="list-style-type: none"> ○ AIS ○ Navtex ○ Water temperature and deep sounder by NMEA • professional vector charts from Spain to Greece • 2. monitor (sun readable) and keyboard on flybridge • protected by uninterrupted power supply
Autopilot:	Robertson AP45 with remote Control on Fly
Radar:	Furuno 72 mi & Furuno 48 mi with Nav plotter
Electronic chart:	B & G LCD chart plotter as backup for Nav-Computer
GPS:	Furuno satellite compass SC-50 (new 2008)
Deep Sounder:	VDO

Communication and Satellite Equipment

Inmarsat-M:	Saturn
Navtex:	Transas Navtex
SAT-Mobile:	Global star
GSM/GPRS/3G:	Internet-router with Skype phone (new 2007)
VHF:	Simrad RS87 VHF-DSC with second station on fly, intercom to aft deck and 2 megaphones incl. fog signals
Telephone exchange:	Panasonic, 8 stations, shore line possible
VHF hand held radio:	ICOM
Printer / fax:	HP inkjet (new 2008)

Entertainment Equipment

Multimedia System:	Vista Media Centre (Video, DVD, Music, Photos) (new 2007)
Satellite:	Seatel 2494
Music system:	Multiroom SONOS, 6 zones (new 2007) <ul style="list-style-type: none">• MP3-Archiv• Internet radio• 3 Interactive remote controls• IPod- / I phone-Integration• 5 pairs Bose loudspeaker, 1 pair loudspeaker JBL and 2 canton subwoofer
TV:	Sony Bravia 32" LCD, Full-HD (new 2007)

Domestic Appliances, Equipment and Laundry

Refrigerator:	2 x Bosch in galley (new 2007), 1 extra in salon (new 2006)
Freezer:	2 x Bosch in galley (new 2007), 1 extra in salon
Oven:	Bosch (new 2008)
Stove:	Bosch (new 2008)
Coffee machine:	Jura Impressa (new 2007)
Exhaust hood and fan:	Bosch (new 2008)
Microwave:	Bosch (new 2008)
Icemaker:	TCM (new 2007)
Dishwasher:	Miele
Washing machine/Dryer:	Teka 6 + 3 kg (new 2007)

Accommodation

7 guests in 4 cabins and 4 crew in 2 cabins

Owner

Cabin: 1 large double cabin with settee, walk-in wardrobe, cupboards, make up table, shoe cupboard, safe,
Berths: King berth
Bathroom: En-suite with full size bathtub, toilet, bidet

Guest Port

Cabin: twin cabin with 1 wardrobe and cupboards
Berths: 2 single
Bathroom: En-suite with full size bathtub, toilet, bidet

Guest Starboard

Cabin: twin cabin with 2 wardrobes and cupboards
Berths: 2 single
Bathroom: En-suite with full size bathtub, toilet, bidet

Guest Single

Cabin: single cabin with cupboards
Berths: 1

Crew

Cabins: 2 cabins with 2 twin, 1 Safe, 1 with access from foredeck
Shower rooms: 2
Crew Mess Bench, dining table

Interior Finish

Van Besouw Carpet in all cabins and salon (new 2006)
All bathrooms, galley, bridge floors in varnish wood
Walls in ash

Deck Equipment

Anchors:	2 x 100 kg Anchor with admiralty pattern chain, 100 m x 14 mm
Crane:	Opacmare telescope crane 3030/33 for tender, 500 kg (2006)
Windlass:	Lofrans windlass Ercole with RF-remote control 2 x Lofrans capstans of aft deck for docking
Passarelle:	Opacmare telescope passarelle 4994/29 (2006), 2 remote control
Bathing ladder:	Removable stainless steel swim ladder with teak
Bimini top:	Bimini top over steering position Umbrella over seating area

Tender and toys

Tenders:	Novourania 430 with Yamaha 70 hp (out boarder new 2005) Optimist sailing boat for children (new 2007)
Toys:	2 pairs water ski, inflatable kayak for 2, tube, rocket, 2, 5 m rubber dinghy, snorkelling equipment.
Supplement :	Air compressor for toys in engine room

Safety

Liferafts:	BFA Pacific, 8 person (new 2005)
Life jackets:	8 x Secumare automatic life jackets with lights 6 x solid life jackets
Fire –fighting equipment:	FM-200 fire extinguishing system in engine room (new 2005) 3 x CO2 extinguisher (new 2005) 6 ABC extinguisher (new 2005)

Safety continued

Alarms:	Fire alarm in engine room Smoke alarm sensors in all areas (new 2005) Bilge Alarm (alarm on bridge and crew mess) Carbon monoxide alarm in engine room (new 2005)
EPIRB:	McMurdo G4A with GPS (new 2005)
Bilge pumps:	2 x Gianneschi & Ramacciotti EM112/4 Build under Lloyd's, not in class since 1998

Classification

Class:	
MCA:	Possible, about 15.000 € to invest

Comments

- Classic exterior layout with the convenience of a modern yacht
- Extremely seaworthy steel yacht
- Transatlantic range and equipment (steel plates for the windows)
- Very reliable systems with backup system for all important tasks
- 4 underwater lights astern
- 10 weeks exterior refit on shipyard in 2007
- Tools and spare parts are on board

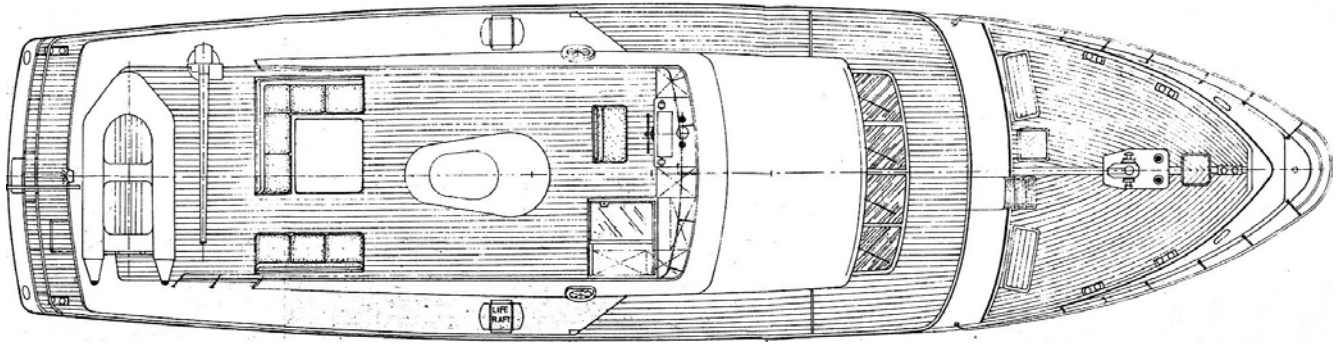

Flybridge

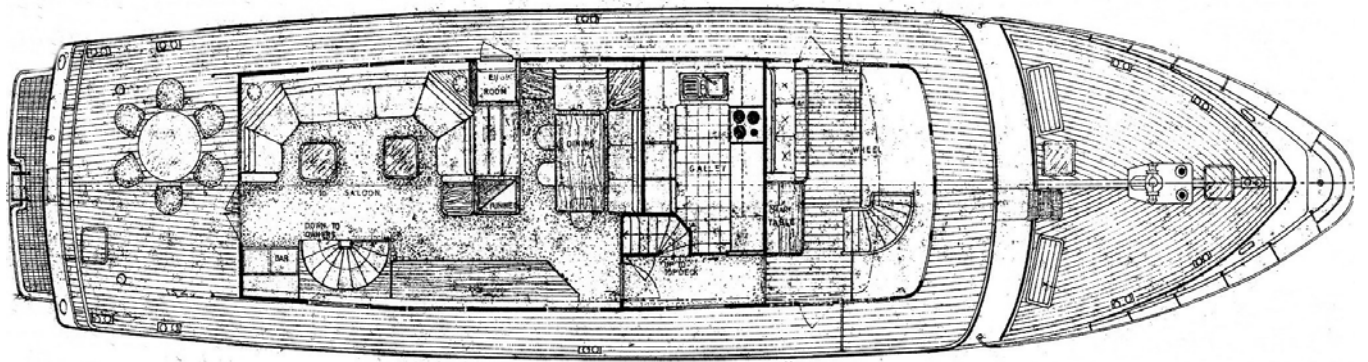

Main deck

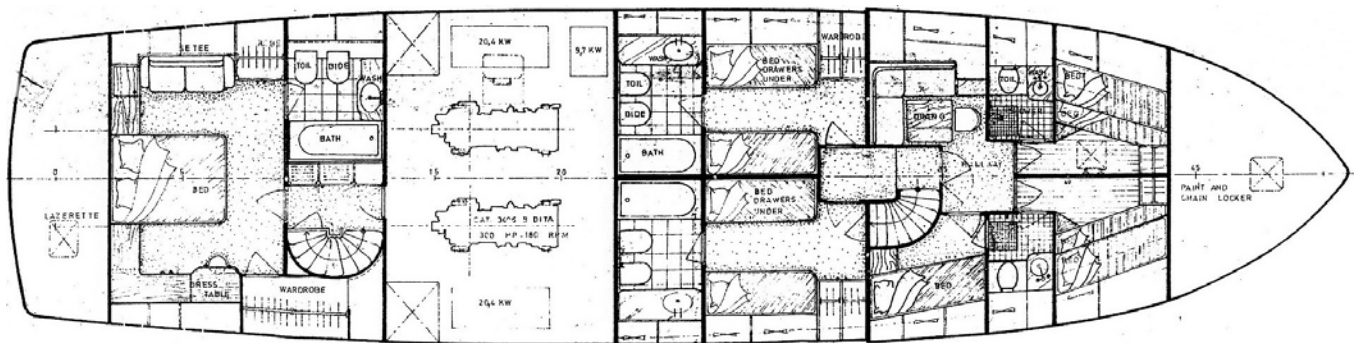

Lower deck



1. Salon



2. Dining



3. Master cabin



4. Master bathroom



5. Guest bedroom (twin)



6. Guest bathroom



7. Crew cabin



8. Crew mess



9. Galley



10. Helm Station



11. Aft deck



12. Bar.co

Disclaimer

The Company offers the details of this vessel in good faith but cannot guarantee or warrant the accuracy of this information nor warrant the condition of the vessel. A buyer should instruct his agents, or his surveyors, to investigate such details as the buyer desires validated. This vessel is offered subject to prior sale, price change, or withdrawal without notice.